

Fluid control valve(2/2 way)

2L Series (Direct-acting and normally closed)



2L

Specification

Type\Item	Port size①	Orifice size (Φmm)	Cv	Valid area or section(mm²)	Weight ② (g)	Max.operating pressure differentia		Proof pressure	
						MPa	psi	MPa	psi
2LH030	−06 1/8"	2.0	0.18	3.0	300	2.0	300	3.0	450
	−08 1/4"				290				
2L030	−06 1/8"	3.0	0.33	6.0	300	1.0	150		
	−08 1/4"				290				
2LH050	−10 3/8"	4.0	0.55	10.0	600	2.0	300		
	−15 1/2"				590				
2L050	−10 3/8"	5.0	0.83	15.0	600	1.0	150		
	−15 1/2"				590				

① PT thread, NPT thread and G thread are available.

② The weight in the table is the terminal valve's weight, 2L030 series grommet valve's weight is 10g less than terminal's. 2L050 series grommet valve's weight is 20g less than terminal's.

Symbol



Product feature

1. Direct acting and normally closed type 2/2 way solenoid valve. Its high sensibility allows it to change direction quickly;
2. It has wide pressure range, including standard high pressure (H) to choose from;
3. It is compact, small size and light weight. It is easy to install and dismantle.
4. The valve body is made of SUS304. Its coil has a Heat resistance classification of Class H. The standard seal material is PTFE(Teflon) which is suitable for a variety of working medium such as water with high temperature and vapour.
5. The protection class of the coil is IP65 and there is a choice for grommet or terminal electrical entry.

Valve's specification

Acting	Direct acting				
Initial stats	Normally closed				
Adaptable fluid ①	Steam, High temperature Water, Oil				
Viscosity limit	Under 20CST				
Ambient and fluid temperature(°C)		Oil	Water	Steam	Ambient
	Max.	150	150	183	100
	Min.	-10.2	1	-	-20

① Note: Please refer to P121 for detail of other's fluid.

② Note: 50CST or less.

Inner structure

2L030(Terminal)

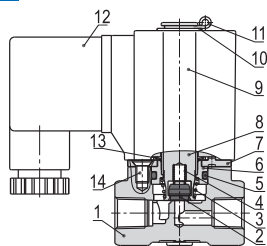

No.	Item	No.	Item	No.	Item
1	Body	6	Fixed cap	11	E Clip
2	Airtight ring	7	Fixed plate	12	Connector
3	Spring	8	Movable core	13	Bead flange
4	Spring	9	Coil assembly	14	Screw
5	O-ring	10	Washer		

Specification of coil

Valve type	Coil type	Power type	Frequency (Hz)	Voltage range	Electrical entry	Power Consumption (VA/W)	Insulation	Temp. rise(°C)
2L□030	CDA116 CLA116	AC	50	± 15%	Terminal (CDA)	10.0VA	Class H	35
		DC	—	± 10%		8.0VA		30
2L□050	CDA170 CLA170	AC	50	± 15%	Grommet (CLA)	6.5W		30
			60	± 10%		25.0VA		60
		DC	—	± 10%		22.0VA		55
			—	± 10%		10.5W		40

Ordering code

2L H 030 08 A □ □									
Model			Thread type						
2L: 2/2 way direct-acting and normally closed			Blank: PT						
			T: NPT						
			G: G						
Pressure condition			Electrical entry						
H: High pressure			Blank: Terminal						
Blank: Standard			I: Grommet						
Size series			Voltage						
030: 030 Series			A: AC220V						
050: 050 Series			B: DC24V						
Port size			C: AC110V						
030 Series			E: AC24V						
			F: DC12V						
050 Series									

Ordering code of accessories

Ordering code of accessories is the same as 2S series valve's, Please refer to P96 for details of ordering code.

Fluid control valve(2/2 way)

2L Series (Direct-acting and normally closed)

Flow chart

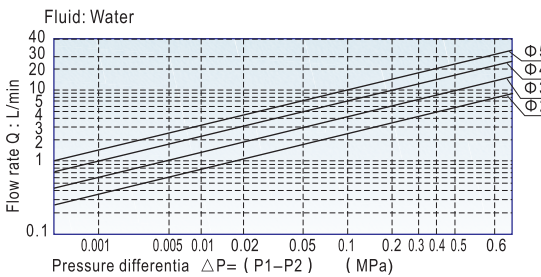
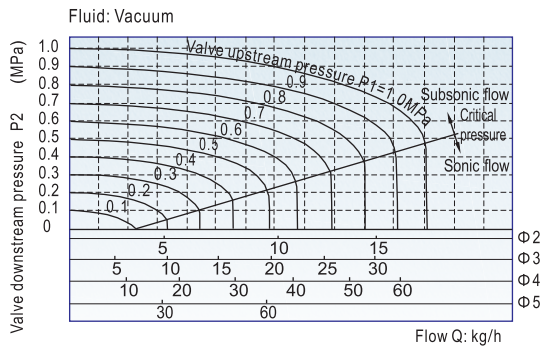

Dimensions

2L□030(Terminal)

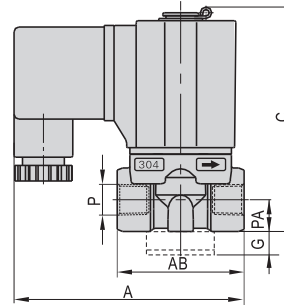
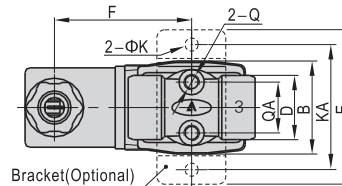

2L□050(Terminal)

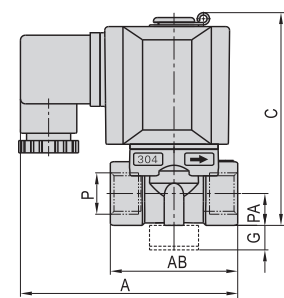
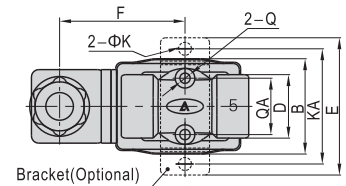

Type\Item	A	AB	B	C	D	E	F	G	K	KA	P	PA	Q	QA
2L□030-06	72.5	40	29.5	71	20	49	43.5	10	5.3	40	1/8"	10	M5	16
2L□030-08	72.5	40	29.5	71	20	49	43.5	10	5.3	40	1/4"	10	M5	16
2L□050-10	89.5	52	39	87	26	56	51	10	5.3	48	3/8"	13	M5	23
2L□050-15	89.5	52	39	87	26	56	51	10	5.3	48	1/2"	13	M5	23

2L□030(Grommet)

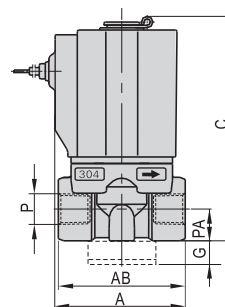
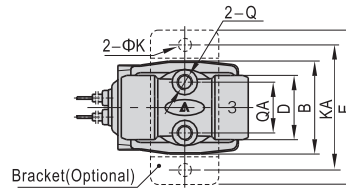

2L□050(Grommet)

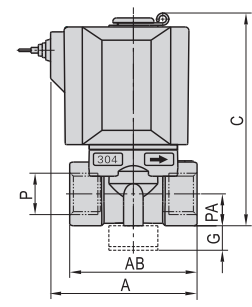
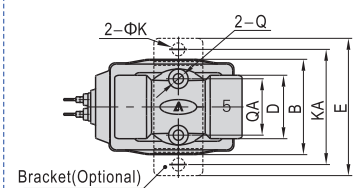

Type\Item	A	AB	B	C	D	E	G	K	KA	P	PA	Q	QA
2L□030-06	41	40	29.5	71	20	49	10	5.3	40	1/8"	10	M5	16
2L□030-08	41	40	29.5	71	20	49	10	5.3	40	1/4"	10	M5	16
2L□050-10	60	52	39	87	26	56	10	5.3	48	3/8"	13	M5	23
2L□050-15	60	52	39	87	26	56	10	5.3	48	1/2"	13	M5	23



2L